

**Specifications for: 1/2"-13 X 1-1/2" Hex Socket Set Screws, Cup Point, UNC Coarse Thread, Alloy Steel, Black Oxide, Holo-Krome**

**Notes:**

- Category: Set Screws
- System of Measurement: Inch
- Head Style: Headless
- Drive Style: Hex Socket Drive
- Pitch: UNC Coarse Thread
- Threading: Thread Class 3A
- Thread Direction: Right-Hand Thread
- Point: Cup Point
- Material: Steel
- Material Grade: Alloy Steel
- Material Processes: Heat Treated
- Coating: Oxidized
- Coating Color: Black
- Origin: Made in U.S.A.
- Standards and Specifications: ANSI B18.3 and ASTM F912

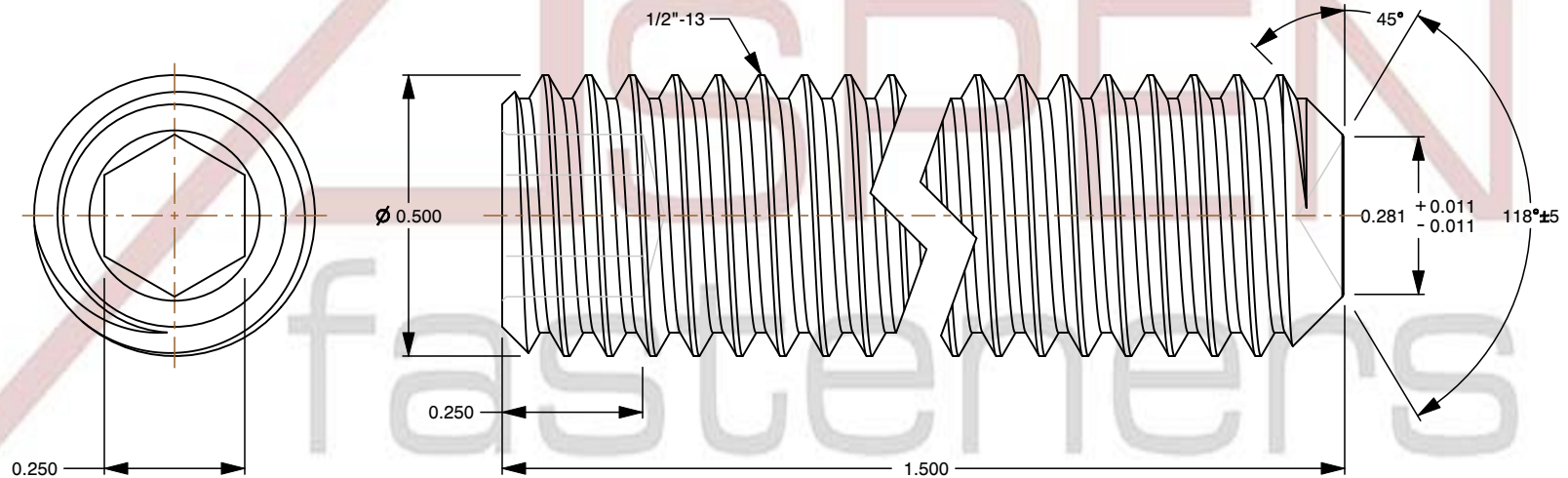
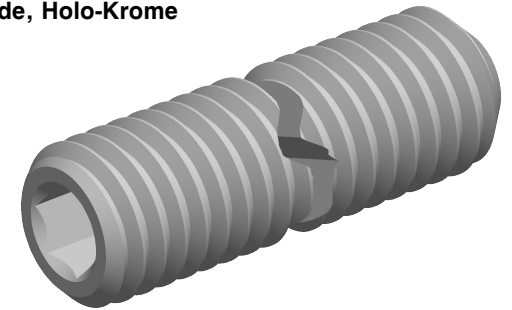

This file and any associated information and specifications are provided for reference and evaluation purposes only and is subject to change without notice. Aspen Fasteners Inc. makes no representations, warranties, or guarantees as to the appropriateness, accuracy, completeness, or suitability for any purpose of the file, information or specifications. You are solely responsible for the use of the file, information, or specifications.

This document is the property of Aspen Fasteners Inc. and the information it contains may not be reproduced, disclosed, or shared with any third party without the expressed written permission of Aspen Fasteners Inc.

SCALE 3.000

**PRODUCT NAME**  
1/2"-13 X 1-1/2" Hex Socket Set Screws,  
Cup Point, UNC Coarse Thread, Alloy Steel,  
Black Oxide, Holo-Krome

PART NUMBER: HK018-1213X112X14

UNIT  
INCHES

ISSUED  
2025-06-25

SHEET 1 of 1