

**Specifications for: 1/2"-13 X 15" Carriage Bolts, Round Head, Square Neck, Part Thread, Grade 5 Steel, Zinc**

**Notes:**

- Category: Carriage Bolts
- Head Style: Round Head
- System of Measurement: Inch
- Head Style Detail: Square Neck
- Head Markings: Three radial lines 120 degrees apart and manufacturer ID
- Thread Length: Part Thread
- Thread Direction: Right-Hand Thread
- Material: Steel
- Material Grade: Grade 5 Steel
- Coating: Zinc Plated
- Coating Color: Clear
- Standards and Specifications: ASME B18.5 and SAE J429

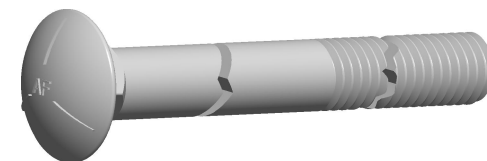

“AF” IS MEANT TO REPRESENT THE MANUFACTURER’S ID MARKING AND WILL VARY DEPENDING ON THE MANUFACTURER OF THE PARTS..

